

From: [REDACTED]
To: info@monaoffshorewind.com
Cc: [Mona Offshore Wind Project](#)
Subject: EN010137 – Fferm Wynt Alltraeth Mona / EN010137 – Mona Offshore Wind Farm Notification of Proposed Changes
Date: 02 December 2024 17:28:49
Attachments: [REDACTED]

Thank you for the opportunity to comment on the proposed changes to the DCO application for the above project.

I have reviewed the proposed changes and draw the applicant's attention to Change 4 potentially impacting on SPMs apparatus which is an important customer infeed to the substation itself, as shown in the photo below and on the attached map extract. SPM would appreciate the applicant explaining to SPM how any impact can be managed and until this happens, SPM is unable to confirm it has no objections to this change.

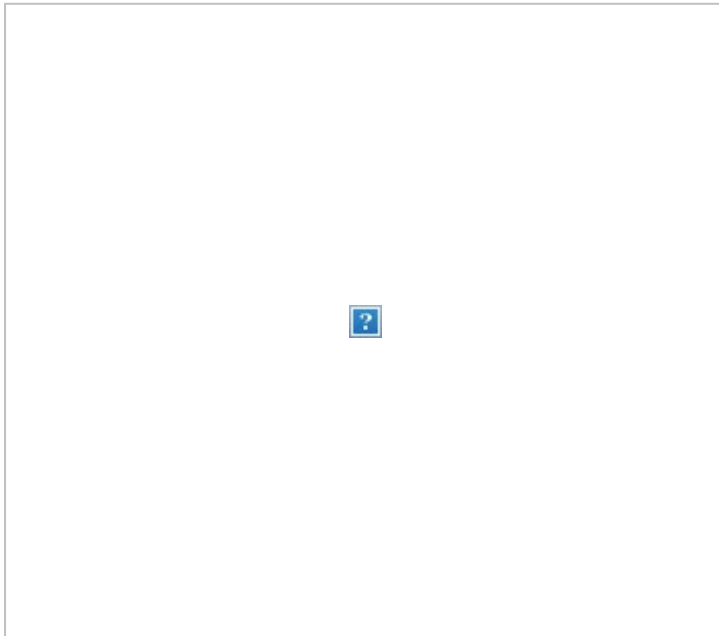

I would be pleased to discuss the above at any time.

Regards
Steve



[REDACTED] | Senior Environmental Planner | Land & Planning
Tel: [REDACTED] | Int: 45656 | Mob: [REDACTED]

SP Energy Networks, 3 Prenton Way, Prenton Merseyside CH43 3ET
Follow us



Internal Use

Please consider the environment before printing this email.

If you have received this message in error, please notify the sender and immediately delete this message and any attachment hereto and/or copy hereof, as such message contains confidential information intended solely for the individual or entity to whom it is addressed. The use or disclosure of such information to third parties is prohibited by law and may give rise to civil or criminal liability.

The views presented in this message are solely those of the author(s) and do not necessarily represent the opinion of Scottish Power Energy Networks Holdings Ltd. or any company of its group. Neither Scottish Power Energy Networks Holdings Ltd. nor any company of its group guarantees the integrity, security or proper receipt of this message. Likewise, neither Scottish Power Energy Networks Holdings Ltd. nor any company of its group accepts any liability whatsoever for any possible damages arising from, or in connection with, data interception, software viruses or manipulation by third parties.

EN010137 changes to the application Nov 24 - SPM UMW Extract

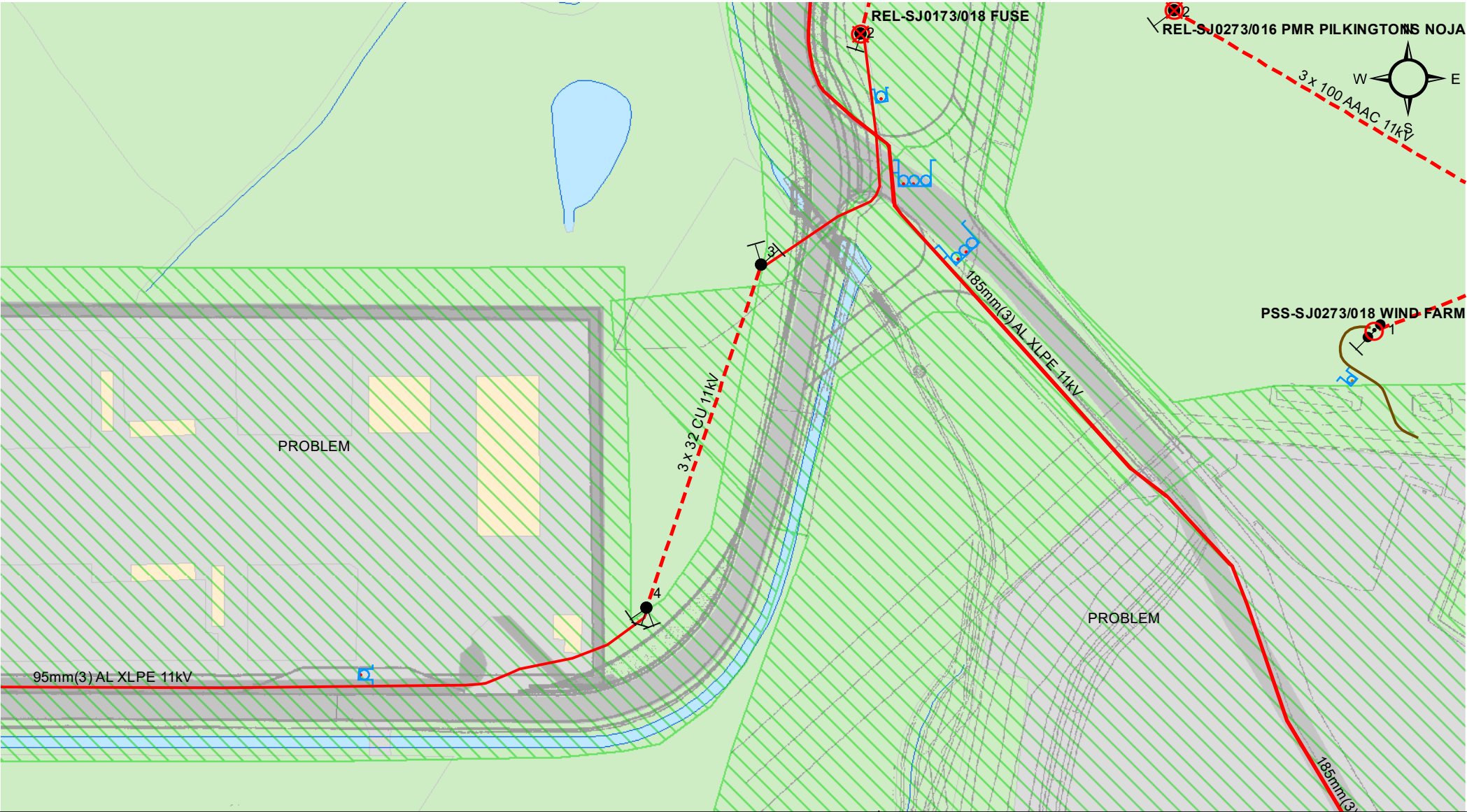

The position and depths of underground and overhead apparatus as indicated on this plan are approximate and are intended for guidance only. The depths may have changed if the land surface levels have altered. You are also informed that the plan may not show, or may inaccurately show, individual property services and services to street lighting installations. The onus of locating the apparatus precisely before commencing any excavations or other works in the immediate vicinity therefore rests entirely upon the person undertaking or responsible for those works. Before any such works are undertaken the precise location of the apparatus and cables should therefore be ascertained by suitable means. In the event of an emergency or for further assistance please contact 0800-092-9290 (ScottishPower area) or 0800-001-5400 (SP Manweb area).

Reproduced from (or based upon) Ordnance Survey maps by PowerSystems with the permission of Ordnance Survey on behalf of the controller of HMSO.
(c) Crown Copyright Power Systems 100019036.



SP ENERGY NETWORKS
On behalf of SP Manweb plc

SP Manweb plc
Registered Office: c/o PowerSystems
3 Prenton Way, Prenton, CH43 3ET
Registered in England and Wales No 2366937

OVERHEAD LINE

UNDERGROUND CABLES

In Use
Out of Use
Assumed route

VOLTAGE COLOUR KEY		
EHV	132kV	BLUE
	33kV	GREEN
HV		RED
LV		BROWN

Where cables have been laid SINCE 1 OCTOBER 1988, the following depths in mm apply (to the tops of cables or ducts) UNLESS OTHERWISE SHOWN, but see comments. (TO TOP OF CABLE, ADD 75mm FOR BOTTOM OF TRENCH)

	EHV	HV	LV
IN FOOTPATHS :	775	600	450
ACROSS ROADS :	775	700	600
ALONG ROADS :	775	700	600
AGRICULTURAL :	910	910	910

Your attention is drawn to the Health and Safety Executive Booklet HSG47, available from HSE.

DATE 02/12/2024

SCALE 1 : 1,009

MAP REFERENCE 301940,373570

02.25 9 13.5 18
Metres